

A76095-1 VENT CONE IN THE SILO PACK D7,5 M18 CE (1 pcs)

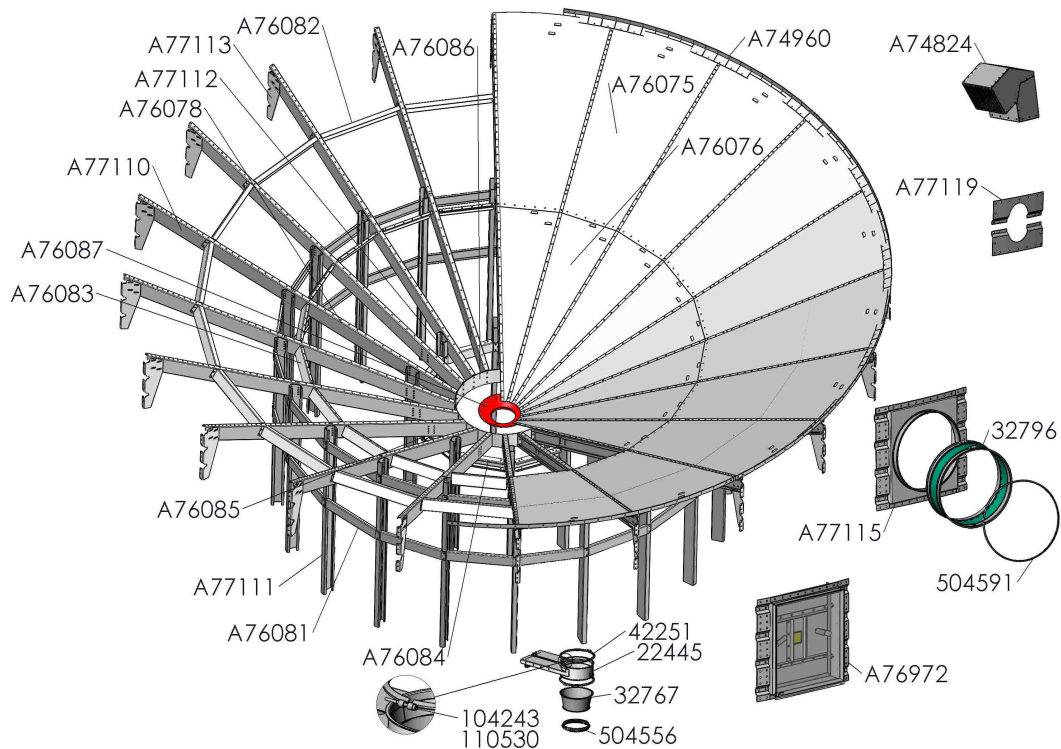

Part no	Name	Qty	Draw. no	Mass	Group
A76075	VENT CONE SECTOR PLATE1 D7,5 M18 CE	20	A76075	44.5	3700
A76076	VENT CONE SECTOR PLATE2 D7,5 M18 CE	20	A76076	18.24	3700
A74960	VENT CONE EDGE FRAMEWORK D5,3 D7,5 M14	9	A74960	4.62	3700

A77120 CONE IN SILO PACKET BEAMS D7,5 M22 CE (1 pcs)

Part no	Name	Qty	Draw. no	Mass	Group
A77110	VENT CONE SECTOR BEAM1 D7,5 M22 CE	20	A77110	12.14	3700
A76078	VENT CONE SECTOR BEAM2 D7,5 M18 CE	20	A76078	13.77	3700
A77111	VENT CONE LEG OUTER D7,5 M22 CE	20	A77111	13.25	3700
A77112	VENT CONE LEG INNER D7,5 M22 CE	8	A77112	9.12	3700
A76081	VENT CONE SUPPORT1 D7,5 M18 CE	40	A76081	2.68	3700
A76083	VENT CONE SUPPORT3 D7,5 M18 CE	20	A76083	2.19	3700
A76082	VENT CONE SUPPORT2 D7,5 M18 CE	20	A76082	4.67	3700
A77113	VENT CONE SUPPORT CONSOLE D7,5 M22 CE	20	A77113	3.17	3700
A76084	VENT CONE SUPPORT4 D7,5 M18 CE	10	A76084	3.14	3700
A76085	VENT CONE SUPPORT5 D7,5 M18 CE	2	A76085	1.42	3700

A77122 VENT CONE IN THE SILO PACK D7,5 M22 CE (1 pcs)

Part no	Name	Qty	Draw. no	Mass	Group
A76087	VENT CONE OUTLET D250 D7,5 M18	1	A76087	4.04	3700
A76086	VENT CONE HUB D7,5 M18 CE	2	A76086	6.11	3700
A76972	GRAIN SILO MANHOLE M22 CE	1	A76972	46.83	3700
22445	KNIFE SHUTTER D250X100	1	22445	5.92	3500
32767	GRAIN PIPE CHANGE PART D200/D250	1	32767	1.5	3526
A77115	VENT CONE AIR DUCT D7,5-D5,3 D630 M22	1	A77115	18.93	3700
32796	AIR DUCT FLEXIBLE PART D625-223	1	32796	9.3	3536
504591	AIR DUCT BAND D625	2	A71000	0.69	3500
A74824	ROUND SILO ROOF OUTLET 250X300 M13	5	A74824	8.93	3700
A77119	ROUND SILO AUGER COVER PLATE D5,3 D7,5 M22	1	A77119	2.02	3700
42251	BIND 2-PARTS L / L D250	2	42251	0.34	3500
104243	SCREW HEX BALL HEAD 6X70 AM DIN912	8		0.02	2010
110530	NUT M6 ZN 8 DIN934	8		0.002	2010
300410	SEAL MASS BUTYL LIGHT GREY	1			2010
A77262	SCREW PACKAGE 7,5 INNER CONE M22	1	A77262	15	2010
504556	BIND 2-PARTS PIPE / PIPE D200	1	31922	0.27	3500

A77262 SCREW PACKAGE 7,5 INNER CONE M22 (1 pcs)

Part no	Name	Qty	Draw. no	Mass	Group
104270	COACH SCREW CUP HEAD ZN 10.9 10X25 AM ISO 7380-1	1200		0.016	2000
102499	BOLT HEX ZN 8.8 12X20 AM DIN933	425		0.03	2010
110570	NUT M12 ZN8 DIN934	425		0.015	2010
107523	DRILL SCREW 6HEX DIN 7504K ZN 5,5x19 PIAS	300		0.004	2010
101810	BOLT HEX ZN 8.8 8X16 AM DIN933	105		0.01	2010
110540	NUT M8 ZN 8 DIN934	105		0.005	2010
104272	COACH SCREW CUP HEAD 10X35 AM ISO 7380-1	22		0.03	2000