

A76093-1 VENT CONE IN THE SILO PACK D5,3 M18 CE (1 pcs)

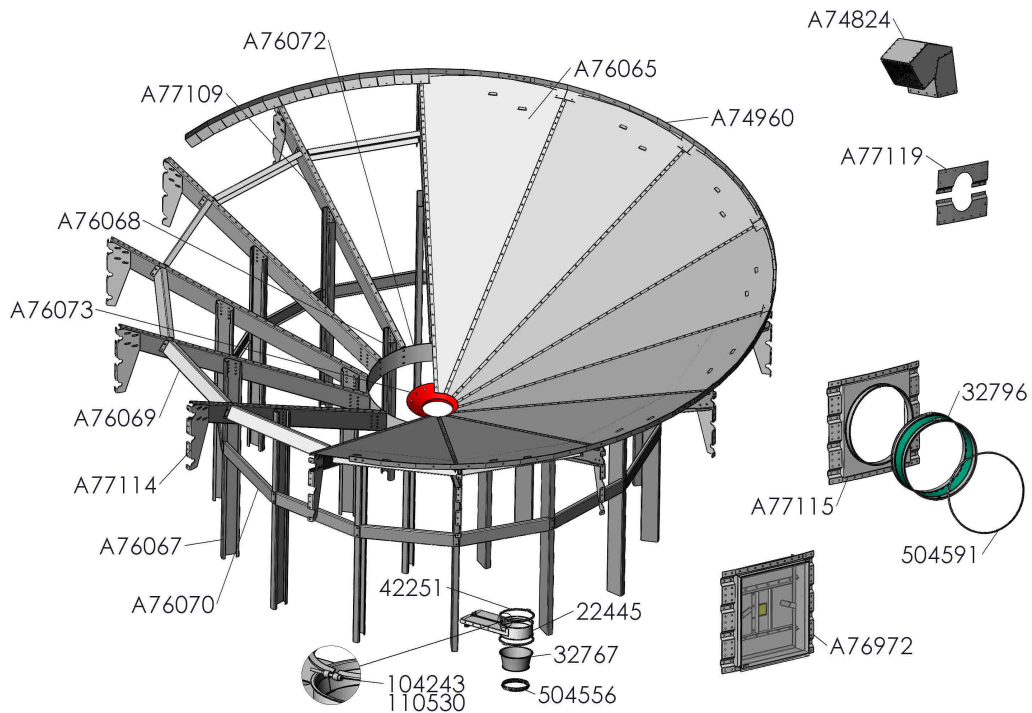

Part no	Name	Qty	Draw. no	Mass	Group
A74960	VENT CONE EDGE FRAMEWORK D5,3 D7,5 M14	6	A74960	4.62	3700
A76065	VENT CONE SECTOR PLATE D5,3 M18 CE	14	A76065	42.94	3700

A77117 CONE IN SILO PACKET BEAMS D5,3M M22 CE (1 pcs)

Part no	Name	Qty	Draw. no	Mass	Group
A77109	VENT CONE SECTOR BEAM D5,3 M22 CE	14	A77109	16.17	3700
A76067	VENT CONE LEG OUTER D5,3 M18 CE	14	A76067	11.95	3700
A76068	VENT CONE LEG INNER D5,3 M18 CE	6	A76068	8.63	3700
A76070	VENT CONE SUPPORT INNER D5,3 M18 CE	14	A76070	2.98	3700
A76069	VENT CONE SUPPORT OUTER D5,3 M18 CE	14	A76069	4.88	3700
A77114	VENT CONE SUPPORT CONSOLE D5,3 M22 CE	14	A77114	2.92	3700
A76972	GRAIN SILO MANHOLE M22 CE	1	A76972	46.83	3700
A76072	VENT CONE HUB D5,3 M18 CE	2	A76072	7.19	3700
504556	BIND 2-PARTS PIPE / PIPE D200	1	31922	0.27	3500
32767	GRAIN PIPE CHANGE PART D200/D250	1	32767	1.5	3526
A77261	SCREW PACKAGE 5,3 INNER CONE M22	1	A77261	10	2010
300410	SEAL MASS BUTYL LIGHT GREY	1			2010
110530	NUT M6 ZN 8 DIN934	8		0.002	2010
104243	SCREW HEX BALL HEAD 6X70 AM DIN912	8		0.02	2010
42251	BIND 2-PARTS L / L D250	2	42251	0.34	3500
A77119	ROUND SILO AUGER COVER PLATE D5,3 D7,5 M22	1	A77119	2.02	3700
22445	KNIFE SHUTTER D250X100	1	22445	5.92	3500
A76073	VENT CONE OUTLET D250 D5,3 M18	1	A76073	4.07	3700

A77261 SCREW PACKAGE 5,3 INNER CONE M22 (1 pcs)

Part no	Name	Qty	Draw. no	Mass	Group
104270	COACH SCREW CUP HEAD ZN 10.9 10X25 AM ISO 7380-1	560		0.016	2000
102499	BOLT HEX ZN 8.8 12X20 AM DIN933	300		0.03	2010
110570	NUT M12 ZN8 DIN934	300		0.015	2010
107523	DRILL SCREW 6HEX DIN 7504K ZN 5,5x19 PIAS	200		0.004	2010
101810	BOLT HEX ZN 8.8 8X16 AM DIN933	84		0.01	2010
110540	NUT M8 ZN 8 DIN934	84		0.005	2010

A77118 VENT CONE IN THE SILO PACK D5,3 M22 CE (1 pcs)

Part no	Name	Qty	Draw. no	Mass	Group
A77115	VENT CONE AIR DUCT D7,5-D5,3 D630 M22	1	A77115	18.93	3700
32796	AIR DUCT FLEXIBLE PART D625-223	1	32796	9.3	3536
504591	AIR DUCT BAND D625	2	A71000	0.69	3500
A74824	ROUND SILO ROOF OUTLET 250X300 M13	4	A74824	8.93	3700